

Owners Manual

Heavy Duty Vinyl Cover
Heavy Gauge Tubular Steel Frame

Snow Blower Cab

Model No. 25016

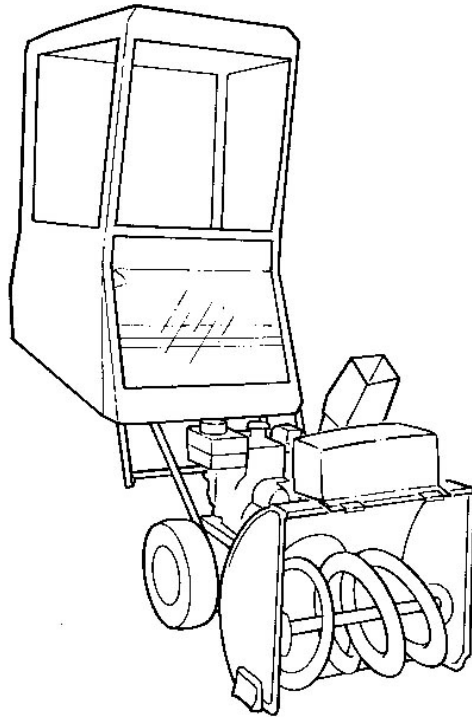

CAUTION:

Before using this product, read this manual and follow all of its Safety Rules and Operating Instructions.

- Safety
- Assembly
- Operation
- Maintenance
- Parts

SAFETY

1. This cab does not provide protection from noise, engine exhaust fumes, chemicals or injury caused by collision, rollover or other accidents.
2. Do not operate the machine in confined areas without proper ventilation.
3. Thoroughly, check the area of operation before using the machine.
4. The cab may restrict your field of vision during use when compared to operation without it.
5. The cab adds height to the machine. Low tree limbs and other overhead structures that did not interfere with operation before the installation of the cab may now become obstacles.

CAUTION

ALWAYS REMOVE THE VINYL COVER FROM THE CAB FRAME BEFORE TRANSPORTING MACHINE ON AN OPEN TRAILER OR IN AN OPEN TRUCK, WHOSE SPEED WILL EXCEED 25 M.P.H.

TABLE OF CONTENTS

SAFETY RULES	2	CARTON CONTENTS	4
FULL SIZE HARDWARE CHART	5	ASSEMBLY	7
REPAIR PARTS ILLUSTRATION	6	MAINTENANCE & STORAGE	3

WARRANTY

LIMITED ONE YEAR WARRANTY ON SNOW BLOWER CAB

For one year from the date of purchase, when this cab is maintained according to the maintenance instructions in the owners manual, OTC will repair any defect in material or workmanship free of charge. If this cab is used for commercial or rental purposes, this warranty applies for 90 days from the date of purchase.

This warranty does not cover repairs necessary because of operator negligence or abuse, including the failure to maintain the product according to the instructions contained in the owner's manual.

This warranty applies only while this product is in the United States.

This warranty gives you specific legal rights, and you may have other rights that vary state to state.

MAINTENANCE & STORAGE INSTRUCTIONS

- A. Periodically check the tightness of all nuts and bolts. If one or more come loose, failure of parts may occur.
- B. Colored vinyl may be washed with the use of a brush and mild liquid soap.
- C. Clear plastic windows can be cleaned with a soft wet towel and mild liquid soap. Do not use a brush on the clear windows, it will cause scratching and dulling of the clear plastic.
- D. Prior to storage, clean colored vinyl and clear windows with soap and water. Allow to dry thoroughly prior to storage.

The model number will be found on a tag attached to the underside of the vinyl cover.

You should record the model number and the date of purchase. Keep this information in a safe place.

MODEL NUMBER: 25016

DATE OF PURCHASE: _____

CARTON CONTENTS

PART #	KEY #	QTY	DESCRIPTION
2226	AA	4	'U' CLAMP, 1 1/16"
7908	BB	4	'U' CLAMP, 1 1/8"
2236	CC	4	'U' CLAMP, 1 1/4"
25017	1	2	HORIZONTAL MOUNTING BAR
25018	2	2	FRAME SUPPORT
25004	3	2	RIB, LOWER
25019	4	2	RIB, UPPER REAR (80°)
25020	5	2	RIB, UPPER FRONT (90°)
25008	6	1	COUNTERWEIGHT SAND BAG
25011	7	1	BRACKET, SAND BAG
25009	8	1	VINYL COVER
25010		1	HARDWARE PACKAGE (Contents listed below - HWP)
926	HWP-A	1	CAPSCREW, 1/4-20x1" hex
2186	HWP-B	4	BOLT, 1/4-20x1 1/4" hex
5470	HWP-C	4	BOLT, 1/4"-20x1 3/4"
5144	HWP-D	4	BOLT, 1/4"x2 3/4"
929	HWP-E	4	BOLT, 1/4"x3"
730	HWP-F	13	LOCKNUT, 1/4-20
9230	HWP-G	2	CAPSCREW, 5/16"x1 1/4" hex (Sand bag clamps)
9828	HWP-H	1	VINYL CAP, 1/4"x1"
9277	HWP-I	2	COVER PLUG, 3/4" ROUND
9833	HWP-J	4	'U' CLAMP, 3/4"

HARDWARE SHOWN ACTUAL SIZE

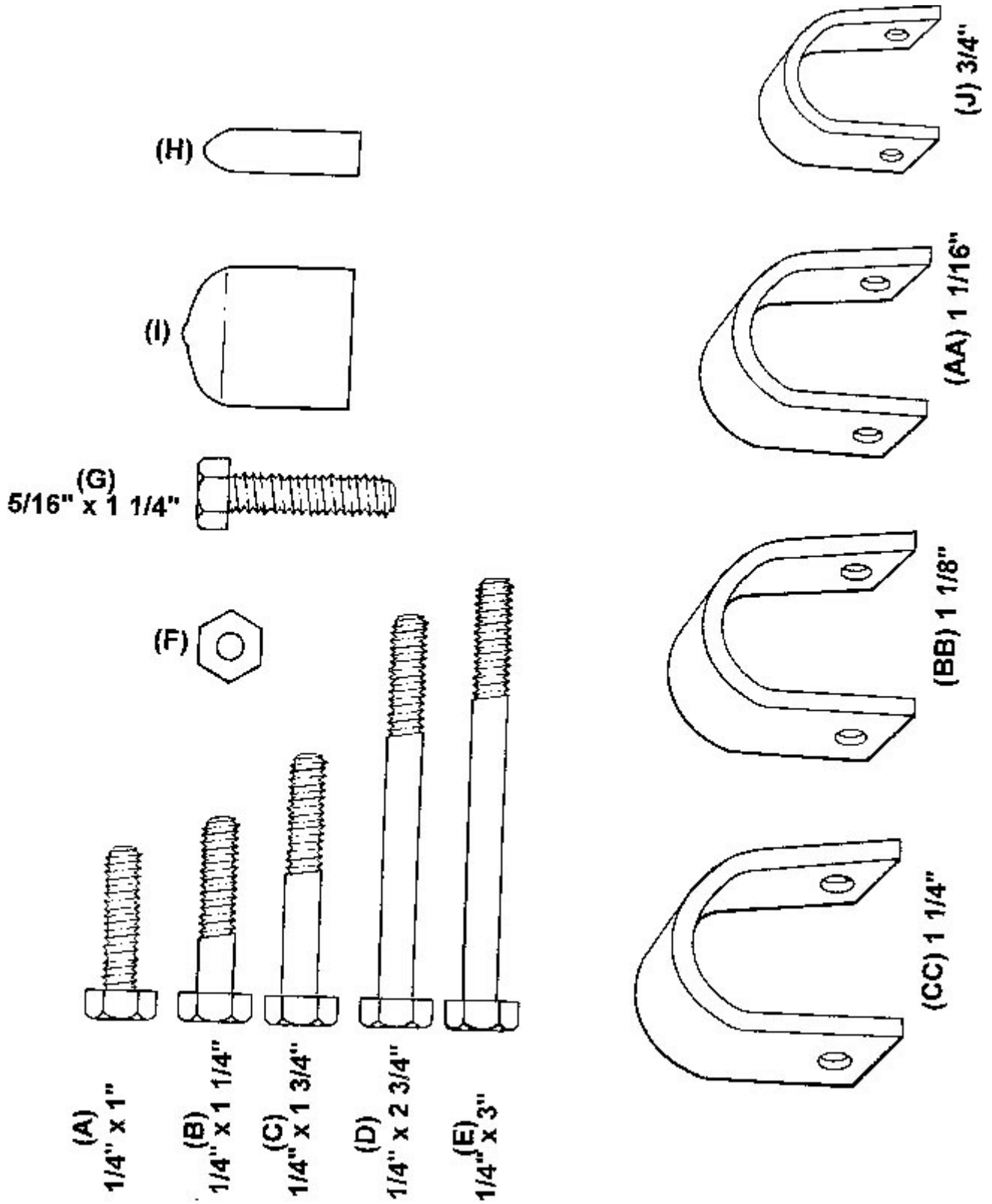

SNOW BLOWER CAB 25016

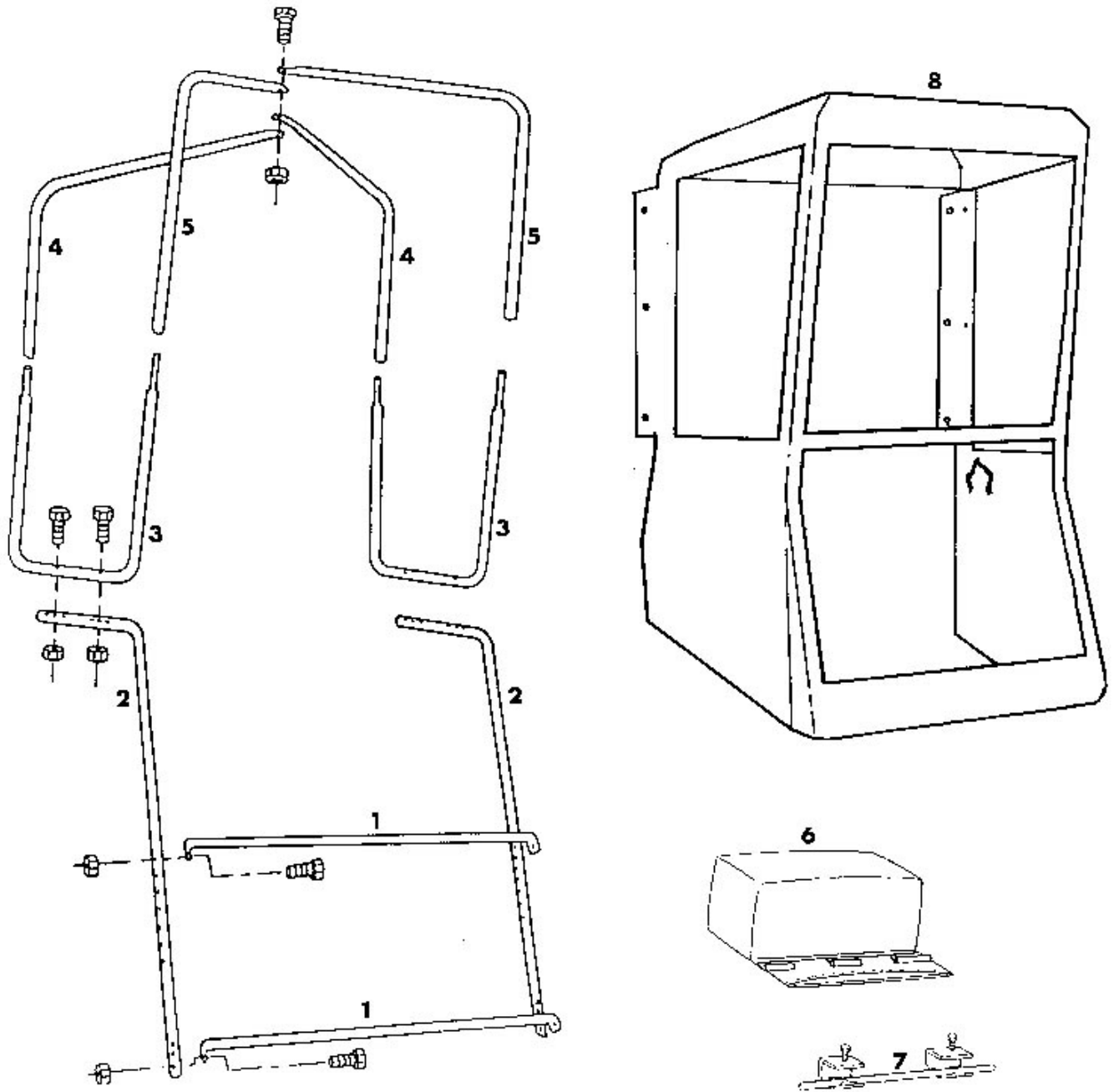

FIGURE 1

INSTALLATION INSTRUCTIONS

READ INSTRUCTIONS COMPLETELY BEFORE BEGINNING INSTALLATION.

MACHINE MUST BE OFF AND COOL BEFORE INSTALLING

TOOLS NEEDED:

TAPE MEASURE

2 - 7/16" WRENCH

1 - 1/2" WRENCH

1 - 10" ADJUSTABLE WRENCH

13 - 15 lbs. of sand

STEP 1; SEE FIGURE 2-A:

ASSEMBLE:

SAND BAG BRACKET [7]

COUNTERWEIGHT SAND BAG [6]

- A. Lay the empty COUNTERWEIGHT SAND BAG [6] on a flat surface. The side with the snap tab should be on top.
- B. Lay the SAND BAG BRACKET [7] on top of the sand bag so that the rod is down and the clamps are open away from bag.
- C. Slip one end of the rod into the small pocket between the snap tab and the outside edge of the bag.
- D. Grasp the clamp in one hand and hold the opposite small pocket between the thumb and forefinger of the other hand. Pull the bracket and small pocket away from each other until you can slip the end of the rod into the pocket. (The bag will stretch to allow the rod to slip into the pocket.)

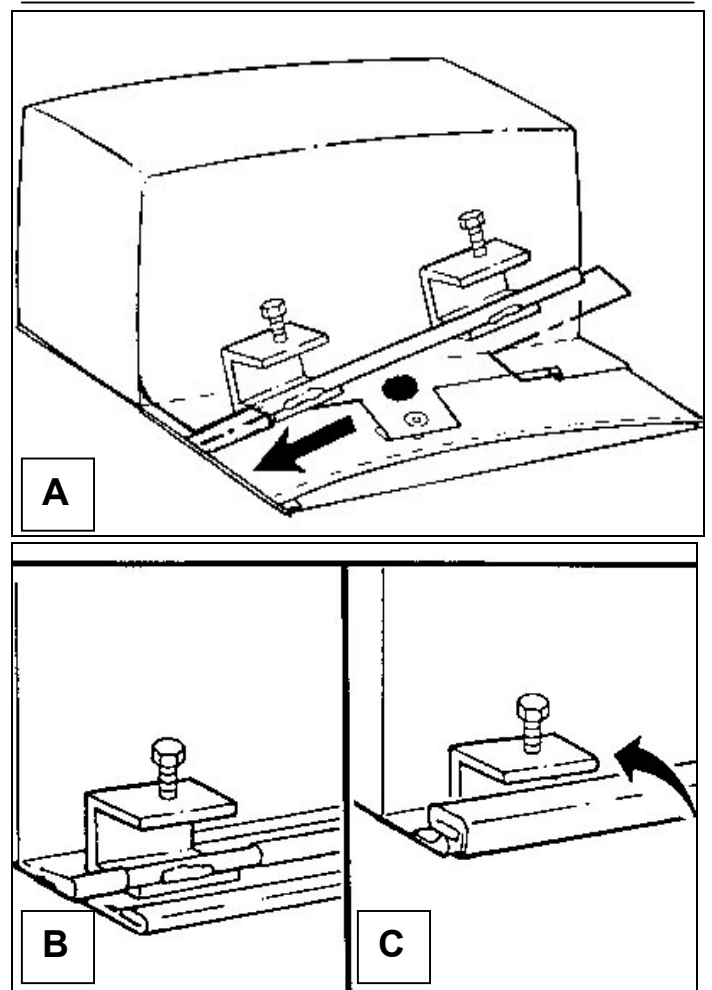

FIGURE 2

- E. Fasten the snap tab around the rod between the clamps.
- F. Fill COUNTERWEIGHT SAND BAG with a minimum of 13 pounds of dry sand.

STEP 2; SEE FIGURE 2 & 3:

INSTALL:

COUNTERWEIGHT SAND BAG [6 & 7]

- A. See 2-A: Start two(2) 5/16 x 1 1/4" capscrews into the sand bag mounting bracket clamps. Do not screw in too far.
- B. See 2-B: Close bag by rolling the opening rod up in the opening flap.
- C. See 2-C: Push rolled up rod under sand bag mounting brackets.
- D. See Figure 3: While holding the ends of both the mounting bracket rod and closing rod. Slip the bracket over the top front edge of the auger housing and tighten the bracket capscrews securely to hold the sand bag in place on the machine.

NOTE: Counterweight sand bag should lay on the back side of the auger housing. **Do Not** cover any warning labels. Capscrews in clamps should be checked for tightness before each use of machine.

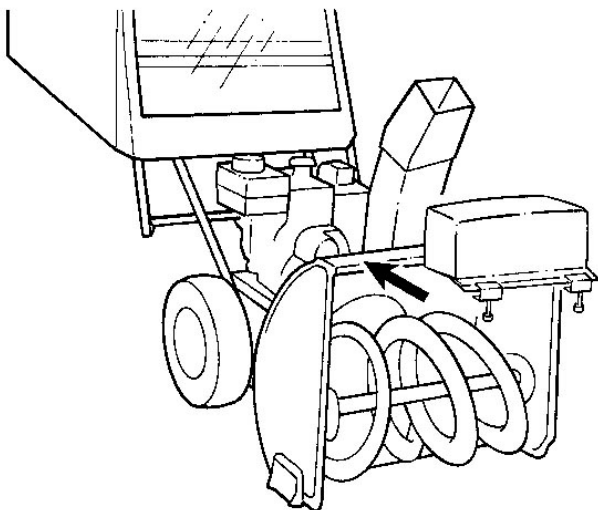

FIGURE 3

STEP 3; SEE FIGURE 4:

INSTALL:

Lower HORIZONTAL MOUNTING BAR [1]

IMPORTANT: Proper placement of the lower horizontal mounting bar is critical for easy completion of the installation.

The preferred mounting location for the horizontal mounting bars is on the top or front side of the machine's handle bar. But, on some machines it may be necessary to mount one or both bars on the back of the machine's handle bar. These instructions are for the standard mounting location which is on the top or front side of the machine's handle bar.

CAUTION: Do not install the horizontal mounting bars in any manner that will interfere with the controls and / or other moving parts.

- A. Find four (4) 3/4" 'U' CLAMPS[J] (Hardware Package) and put one on each end of the HORIZONTAL MOUNTING BARS[1].
- B. Select four (4) 'U' CLAMPS [AA, BB, CC] that fit snugly around the snow blower's handle bar. These clamps should fit slightly loose to snug without being forced.
- C. Place one (1) of the selected 'U' clamps onto the lower part of the handle bar allowing the horizontal mounting bar to be mounted a minimum of 17" and a maximum of 23" from the ground as measured from the center of the hole in the flattened end tab.
See FIGURE 4, for proper orientation.

STEP 3: (CONT.)

D. Using 1/4"x 2 3/4" or 3" bolts, bolt the horizontal mounting bar 'U' clamps to the handle bar 'U' clamps.

See detail FIGURE 4 .

Tighten enough to hold parts in place.

E. Adjust horizontal mounting bar so it is level and there is an equal amount of the bar sticking past each side of the handle bars.

NOTE: On some snow throwers it may become necessary to offset the entire cab to one side in order to clear controls. The offset is better determined after the entire cab is installed in the standard manner.

F. Move horizontal mounting bar up or down the machine's handle bar until it is a minimum of 17" (Optimum) and a maximum of 23" above the ground. This should give 6' 5" of headroom to the inside peak of the cab.

SNUG DOWN BOLTS.

NOTE: Headroom can be increased later if necessary by moving mounting bars higher on handle bars.

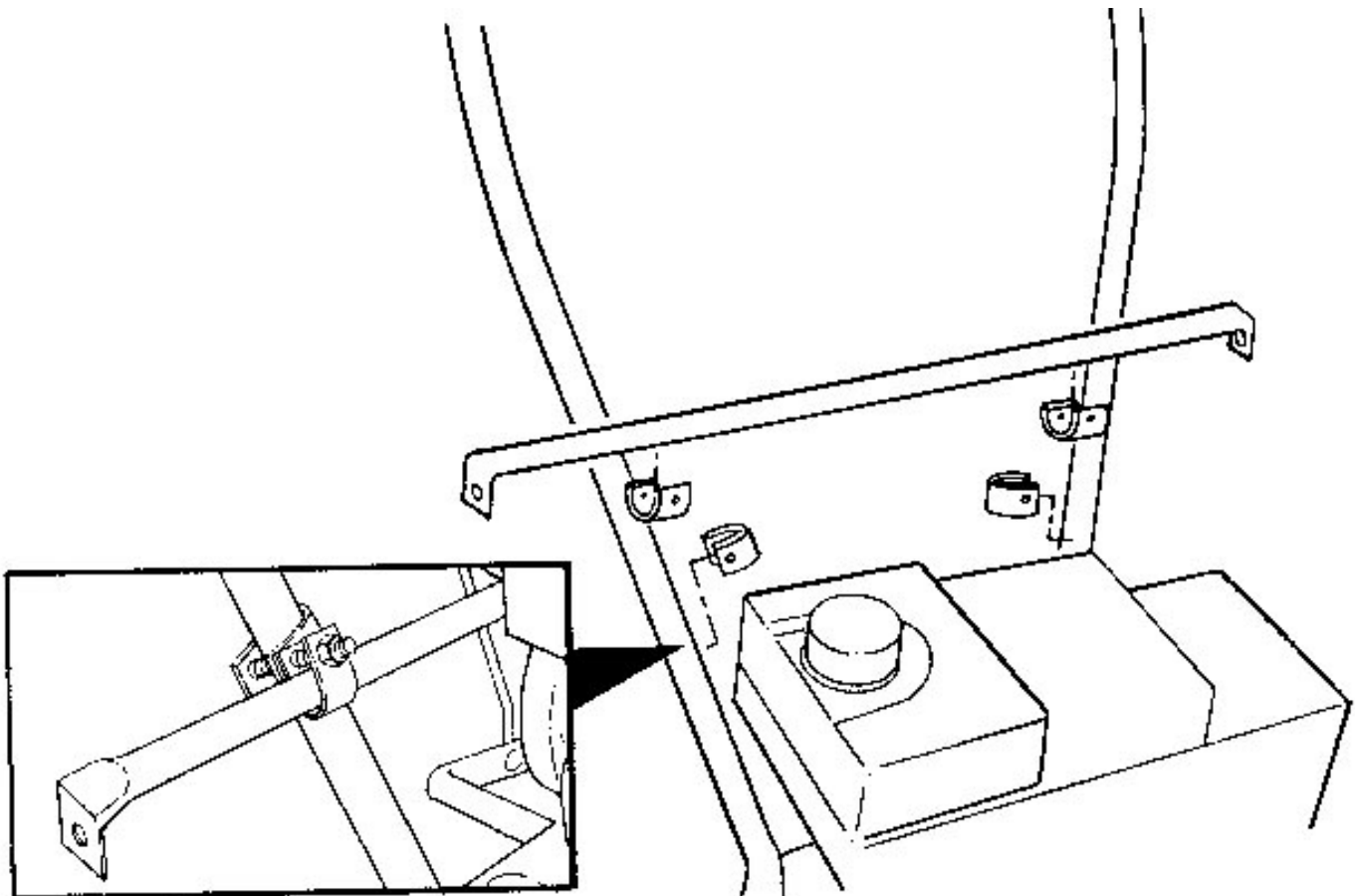

FIGURE 4

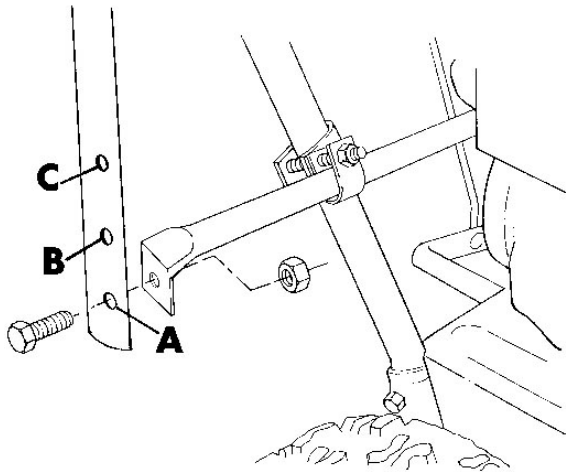

FIGURE 5

STEP 4; SEE FIGURE 5:

INSTALL:

FRAME SUPPORT [2]

- A. Use a hole* in the long leg of the FRAME SUPPORT [2] to bolt to the tab of the lower mounting bar using 1/4"-20 x 1 1/4" bolt & 1/4-20" locknut.

Snug down nut.

* If horizontal mounting bar is:

- 17" - 19" from the ground use hole (A).
- 19" - 21" from the ground use hole (B).
- 21" - 23" from the ground use hole (C).

- B. Repeat procedure for both FRAME SUPPORTS [2].

STEP 5; SEE FIGURE 6:

INSTALL:

Upper HORIZONTAL MOUNTING BAR [1]

- A. To determine the location of the Upper HORIZONTAL MOUNTING BAR [1], raise frame support up until short leg of part is parallel to ground. This should give an approximate position (Any hole may be used) for mounting the upper horizontal mounting bar onto the machine's handle bar.

NOTE: Upper mounting bar should be as far from the lower bar as possible. This bar can be mounted on either the front or back side of machine's handle bar to insure clearance of controls and / or other moving parts.

- B. When proper position has been determined for the upper horizontal mounting bar it can be bolted to the machine's handle bar in the same manner as the lower bar was bolted to the handle bar. See STEP 3, B thru E

CAUTION: *Do not install horizontal mounting bar in any manner that will interfere with controls and / or other moving parts.*

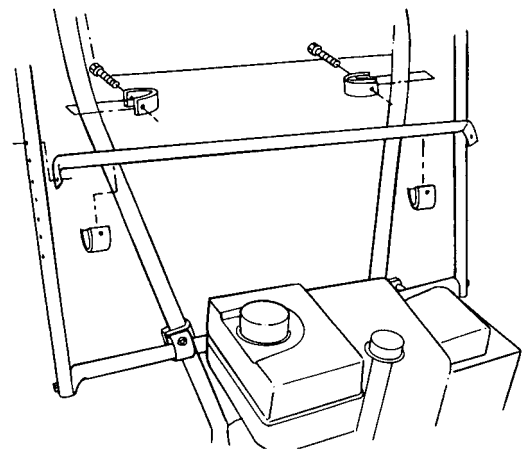

FIGURE 6

STEP 6; SEE FIGURE 6:

ASSEMBLE:

FRAME SUPPORT [2]

Upper HORIZONTAL MOUNTING BAR [1]

- A. Raise frame support up into alignment with upper horizontal mounting bar and bolt on to mounting bar using 1/4"-20x1 1/4" bolt and 1/4"-20 locknut. Snug tight only.
- B. Repeat for the other side.

STEP 7; SEE FIGURE 7:

The short leg of the frame supports should be parallel to the ground and their ends should spread away from each other about 30". If parts are in this position proceed to (STEP 8).

Otherwise follow problem adjustment procedures.

PROBLEM: Frame supports are coming together at rear of machine.

SOLUTION: Remove frame supports from mounting bars and switch sides.

PROBLEM: Frame supports are not parallel to the ground.

SOLUTION: Rotate the lower horizontal mounting bar until the short legs of the frame supports are in the proper position. This is best accomplished by placing an adjustable wrench on the partially flattened end of the horizontal mounting bar to use as a lever.

NOTE: Sometimes the upper horizontal mounting bar may also need to be rotated with lower bar in order to accomplish proper alignment of frame supports. This is especially true if one of the bars had to be mounted on the back side of machine's handle bar.

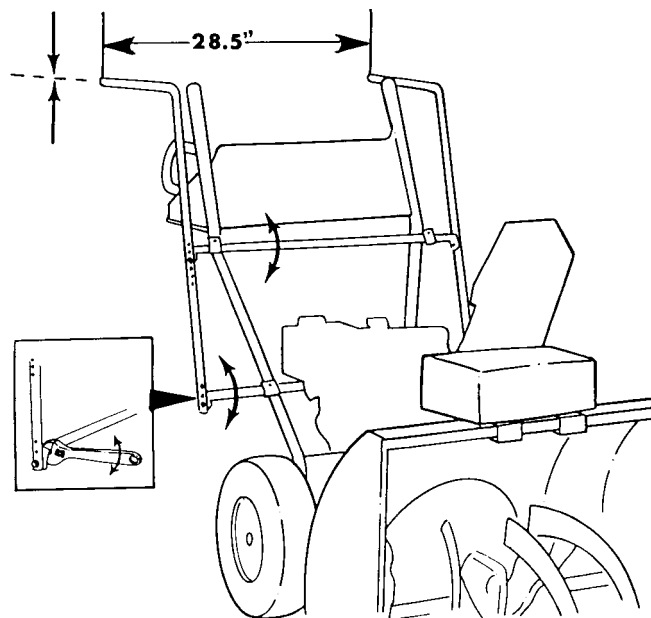

FIGURE 7

STEP 8:

- A. Tighten all mounting bolts.
- B. Push large vinyl cap onto end of each frame support.

STEP 9: SEE FIGURE 1:

INSTALL:

LOWER RIB [4]

NOTE: There are three sets of holes on the frame support arm on which to bolt the lower ribs. Full Forward, Middle and Full Backward. The standard position is in the Middle set of holes. Cab may be moved forward or backward to allow better access to controls and / or operator protection. This can be easily changed after vinyl cover is in place by moving one side at a time and rebolting.

- A. With 100° bend of LOWER RIB [4] pointing toward the front of the machine, use 1/4"-20x1 3/4" bolt and 1/4" locknut, to bolt lower ribs to frame supports at middle set of holes. Repeat for the other side.
Tighten bolts enough to hold parts in place.

STEP 10; SEE FIGURE 1:

INSTALL:

UPPER REAR RIBS [4]

(100° bend in part)

- A. Place tube end of UPPER REAR RIB [7] over tapered end of lower rib.
Repeat for other side.
- B. Bring the flattened ends of the two parts together over head. Slip a 1/4" x 1" capscrew thru the hole in the flattened ends of both parts to temporarily hold parts.

STEP 11; SEE FIGURE 1:

INSTALL:

UPPER FRONT RIB [5]

(90° bend in parts)

- A. Place end of (90° bend) UPPER FRONT RIB [5] over tapered front end of (100° bend) lower rib.
Repeat for the other side.
- B. Bring the flattened ends of the two parts together over head. The flattened ends should lay flat against each other. If not reverse sides for parts.
- C. Remove 1/4"x1" capscrew holding the rear upper ribs and use it to bolt the rear ribs on top of the front ribs. Tighten a nut onto the bolt.

Tighten all bolts securely.

- D. Move UPPER FRONT RIBS until they are 28.5" (Outside to outside) apart from each other.
- E. Place small vinyl cap on end of bolt.

STEP 12:

INSTALL:

VINYL COVER

CAUTION:

Do not install cover when engine is hot

- A. Remove vinyl cover from packaging, being careful not to crease clear plastic windows.
- B. Drape cover over machine's handle bars. Then working from the inside of frame, pull cover up and over frame.
- C. Adjust cover on frame. Fasten snaps at rear of cab around frame. Secure ties to frame supports.

NOTES