



CAB #20091
FOR
Kanga Loader G520, G524, DL520

OPERATION - PARTS LIST - ASSEMBLY

IMPORTANT

READ THIS MANUAL CAREFULLY AND KEEP FOR FUTURE REFERENCE

CAUTION !

REMOVE THE CAB FOR TRANSPORT IN AN OPEN TRUCK OR TRAILER

WARNING !

THIS CAB WILL NOT PROTECT OPERATOR FROM INJURIES CAUSED BY ROLLOVER,
COLLISION, OR OTHER ACCIDENTS



WARNING

This cab is designed to provide foul weather protection only. It does not provide protection from noise, exhaust fumes, chemicals or injury from collision, roll-over, or other accidents.

1. Do not operate machine in confined areas without proper ventilation
2. Thoroughly check area of operation before using machine
3. The cab adds height to the machine. Low tree limbs and other overhead structures that did not interfere with the operation of the machine before, may now be obstacles

MAINTENANCE INSTRUCTIONS

Periodically check all bolts to see that they are tight. If bolts become loose, failure of cab parts may occur.

**DO NOT CLEAN THE CLEAR PLASTIC WINDOWS WHEN THE PLASTIC IS DRY.
THE CLEAR PLASTIC WILL SCRATCH.**

Avoid contact with plastic windows. Keep plastic windows clean by washing them with clear running water and rubbing with your bare hands, only. The use of a rag, sponge or brush will scratch the plastic. Liquid soap may also be used for window cleaning. During freezing weather, an automotive windshield washer solvent may be used.

Use liquid soap and water to clean colored vinyl portions. Scrubbing with a brush or rag is also permitted on the colored vinyl portions

STORAGE INSTRUCTIONS

Prior to storage clean the windows and colored vinyl parts with a mild automotive detergent, rinse with clean water and allow to thoroughly dry, Store cab in a clean dry place out of direct sunlight. Avoid folding plastic windows.

INSTALLATION

READ THIS MANUAL COMPLETELY BEFORE BEGINNING INSTALLATION.

- The right side of the machine is determined from the operator position.
- Do not tighten bolts during assembly unless instructed to do so.
- Park machine on level ground, lower attachments to ground, remove start key.

LIMITED WARRANTY SNOW REMOVAL EQUIPMENT CABS

COVERED BY WARRANTY

ORIGINAL TRACTOR CAB CO., INC., (the "Company") warrants to the owner that each new product listed below is merchantable and free of defects in workmanship and material.

During the warranty period, the dealer from whom the product was bought, or the Company, will provide, free of charge, parts and the shipping costs of parts necessary to correct any defect in workmanship and material.

WARRANTY PERIOD

The company products listed below are warranted for the stated period from the date of the original purchase:

- | | |
|--|---------|
| 1. Cabs for tractors and snow removal equipment | 90 days |
| 2. Company manufactured accessories for above cabs | 90 days |
| 3. Sunshades for lawn and garden tractors | 90 days |
| 4. Repair parts | 90 days |

OWNER'S RESPONSIBILITIES

The owner of a new Company manufactured product must do the following to qualify for warranty service :

1. Retain the original invoice or other proof of purchase to avoid unnecessary difficulties in determining eligibility for warranty work.
2. Notify the dealer from whom the product was bought, or the company, as soon as possible after discovery of a possible defect, and provide proof of original purchase.
3. To notify the company write to: Original Tractor Cab Co., Inc., P.O. Box 97, Arlington, IN 46104.
the owner may , upon notification by the Company, be required to return the defective part, or parts, to the Company for inspection and warranty service.

NOT COVERED BY WARRANTY

The following are not covered by this warranty:

1. Transportation charges to and from servicing dealer or the Company;
2. New products which have been subject to misuse, negligence or accident, or have been altered or repaired in a manner not authorized by the company;
3. Windshield wipers, lights, or accessories that are warranted separately by their respective manufacturers, except Company agrees to make available to the owner whatever warranty benefits may be made available to the Company by the manufacturers.

All implied warranties, except to the extent prohibited by any applicable law, shall have no greater duration than the warranty period for the applicable product, some states do not allow limitation on how long an implied warranty lasts, so the above limitation may not apply to you.

The Companys' liability arising out of warranties representation, instructions, or defects from any abuse, shall be limited exclusively to repair or replacing parts under the condition in the warranty, and in no event will Company be liable for incidental or consequential damages. Some states do not allow the exclusion or limitation of incidental or consequential damages, so the above limitation or exclusion may not apply to you.

This warranty gives you specific legal rights, and you may also have rights that vary from state to state.

Carton Contents: Cab #20091 for Kanga Loader G-520, G-524 & DL520

Key#	Part #	Quantity	Description
1	20092	1	Bracket, RH
2	20093	1	Bracket, LH
3	20040	1	Front Cross Bar
4	20038	1	Post, RH
5	20039	1	Post, LH
6	20042	2	Arm
7	20041	1	Rear Cross Bar
8	20094B	1	Vinyl Cover
	20044	1	Storage Bag
	20095	1	Hardware / Hook & Loop Fastener Package
	786	2	1/4"-20 x 5/8" Cap Screw
	730	2	1/4"-20 Two Way Locknut
		1	54" Adhesive Hook
		1	Alcohol Pad
	9448	2	M8-1.25 X 45 Cap Screw
	317	2	5/16 Flat Washer
	4993	2	1" Square plug for brackets when cab is not in use.



Step 1; See Figure 1:

Install right Bracket (1)

A. Remove the bolts at reference A. Place the right bracket on the frame. Use m8 x 45mm bolts with flat washers to attach the Bracket. Do not tighten at this time.

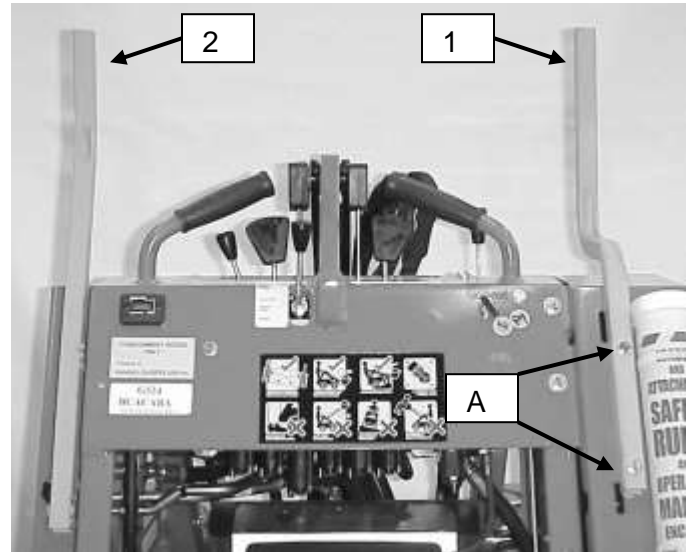

Figure 1

Step 2; See Figure 2:

Install left Bracket (2)

A. Remove the bolts at reference B.

B. Place the left bracket on the machine. Replace the bolts. Do not tighten at this time..

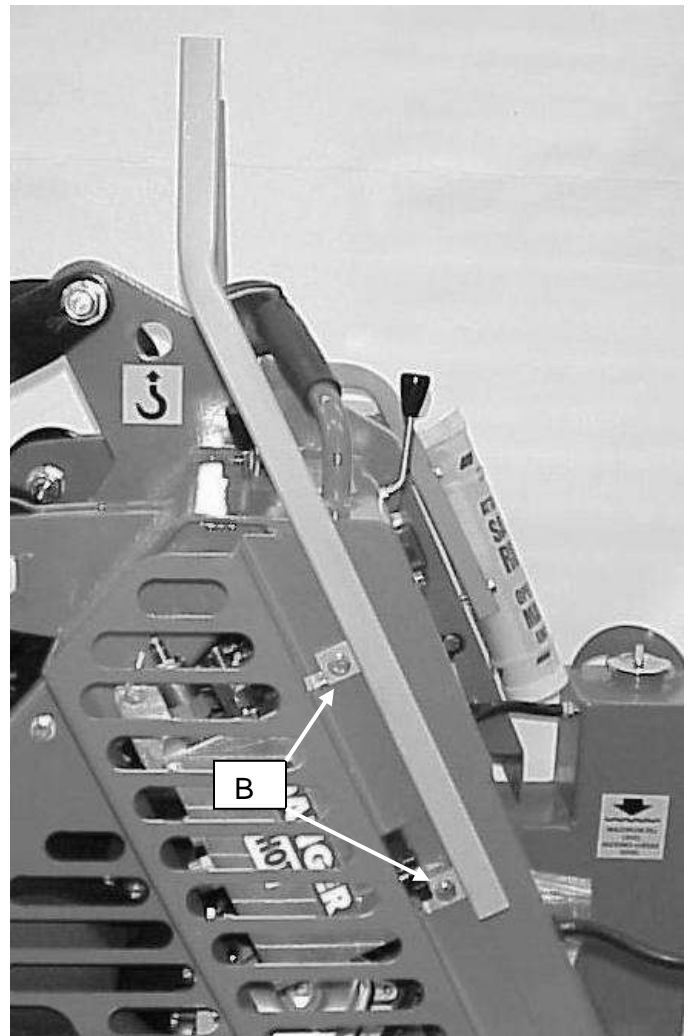

Figure 2

Step 3; See Figure 3:

Install right and left Posts (4 & 5) and Front Cross Bar (3).

A. Insert the square end of the post into the square receiver of the bracket.

NOTE: The tab on the post should be on the front side of the post and pointing to the inside of the machine.

B. Insert $\frac{1}{4}$ " x $\frac{5}{8}$ " bolts into the front cross bar. Place the bolts into the tabs of the post. Add nuts to the bolts and tighten.

C. Tighten the Bracket bolts from steps 1 & 2.

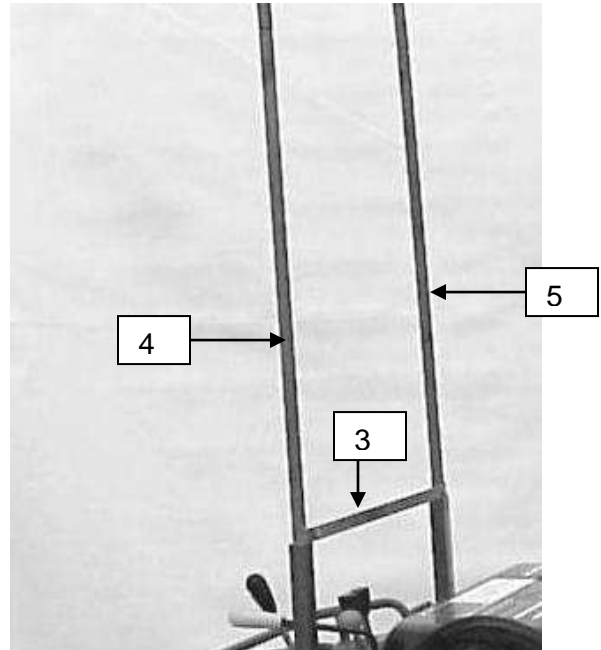

Figure 3

Step 4; See Figure 4:

Install Arms (6) and Rear Cross Bar (7)

A. Place the short end of the arm onto the tapered end of the post.

B. Insert the tapered end of the rear cross bar into the long end of the arm.

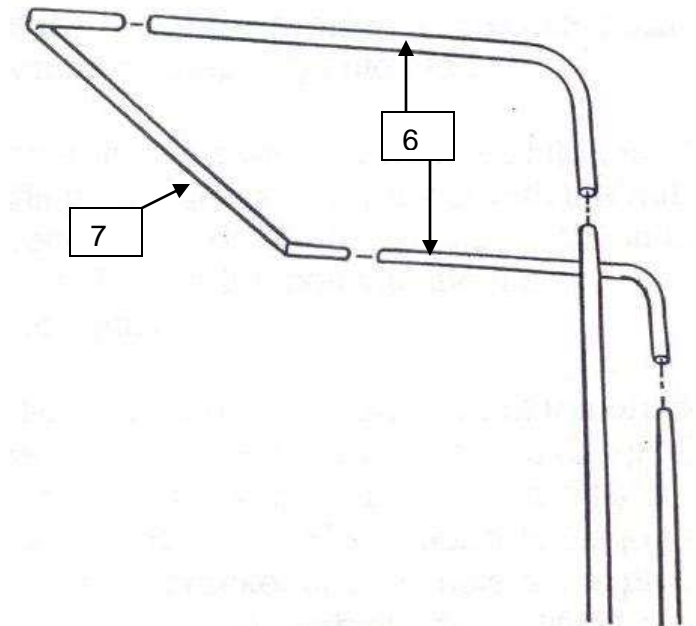

Figure 4

Step 5; See Figure 5:
Install the Vinyl Cover (8)

- A.** Pull the cover up and over the frame and secure the hook & loop fastener around the rear cross bar and the front Cross Bar.
- B.** Cut strips of adhesive hook fastener to match the length of loop fastener sewn to the bottom of the cover.
- C.** Remove all dirt and oil from adhesive fastener area. Clean the area with alcohol pad.
- D.** Place the strips of hook fastener on the sides of the machine to correspond with the cover.

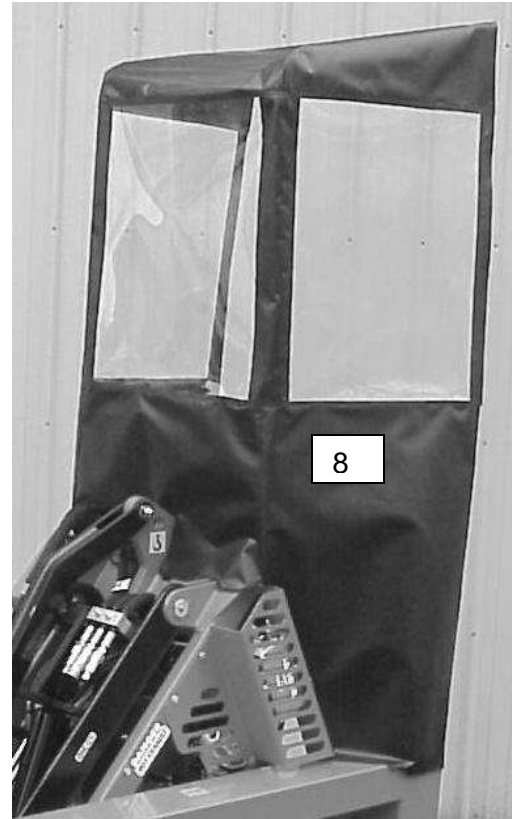

Figure 5

Removal Instructions

Step 6; See Figure 6:

- A.** Fasten the VELCRO strap in the left upper rear corner of the cover around the left arm.
- B.** Open the VELCRO flap around the rear cross bar.
- C.** Pull **one end** only of rear cross bar out of the arm. Allow the rear cross bar to pivot down against the side of the vinyl cover.

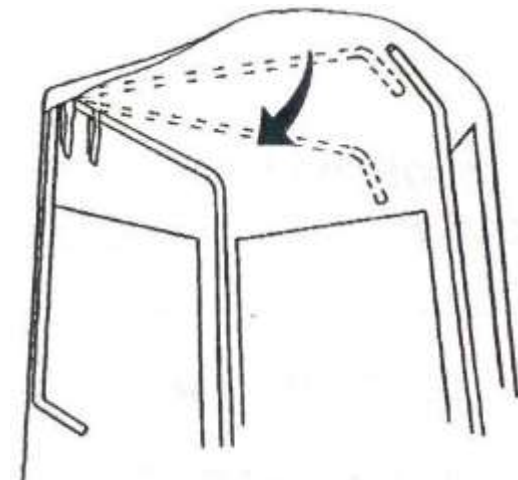

Figure 6

Step 7; See Figure 7:

A. While holding the top part of the cover up, pivot the right arm completely forward against the cover.

B. Still holding the top of the cover up, fold the right side curtain over onto the back of the windshield, allowing the top section to fold diagonally in half, down, under and on itself.

C. Swing the left arm and side curtain over on top of the right side curtain. Allow the top to fold diagonally in half and down between the right and left side curtains.

D. Fold the lower side curtain ends near the bottoms of the side windows.

E. Pull storage bag over the frame and remove from machine.

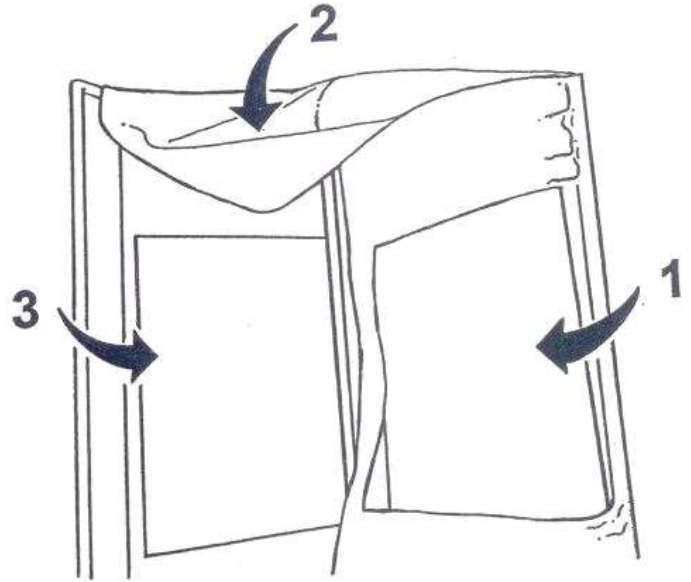

Figure 7

For Replacement Parts Contact:

Original Tractor Cab Co., Inc.

P.O. Box 97 6849 W. Front St.

Arlington, IN 46104

Phone 765-663-2214

Fax 765-663-2101

Email Sales@originalcab.com

Visit us on the web to see our other products.

www.originalcab.com

Cabs for Lawn Tractors, Garden Tractors, Compact Tractors, Snow Blowers, Utility Vehicles

Sunshades for Tractors, Mowers, & Utility Vehicles

Storage Covers for Lawn and Garden equipment. Bug Screen cab enclosures.